

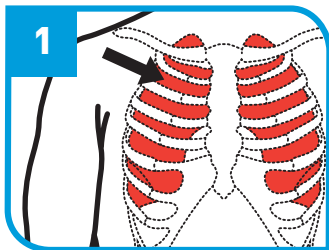

DART

INFORMATION FOR USE



Step 1: Identify the second intercostal space on the anterior chest at the midclavicular line on the injured side.

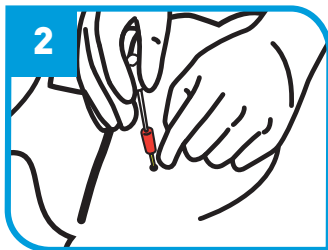

Step 2: Insert the DART into the skin over the superior border of the third rib, midclavicular line, and direct it into the intercostal space at a 90-degree angle to the chest wall. Ensure the DART entry into the chest is not medial to the nipple line and not directed toward the heart.

Step 3: Listen for the sudden escape of air as the tension pneumothorax is relieved. Remove the needle.

Step 4: Reassess. ↻

RESPIRATION



DART

INFORMATION FOR USE

PURPOSE:

This device is a rapid means to relieve a tension pneumothorax in a trauma patient.



- Insert the needle and catheter all of the way to the hub.
- Remove the needle and keep the catheter in place.
- Reassess every 3-5 minutes.

Caution: Federal law restricts this device to sale by or on the order of a physician, or with the descriptive designation of any other practitioner licensed by the law of the State in which he practices to use or order the use of the device; Complete product information and disclosures are available at: combatmedicalsistemas.com/e-labels



h 21-001-IFU-EN
© 2017 Combat Medical Systems, LLC
www.combatmedicalsistemas.com